

**NEW BODIES — INCLUDING COVERED VERSION!**

## Coastal Distribution, LLC



ATHG76725 CDEX #16003  
 ATHG76726 CDEX #16031  
 ATHG76727 CDEX #16078/16112

Era: 2016+

with scrap load

## The CIT Group

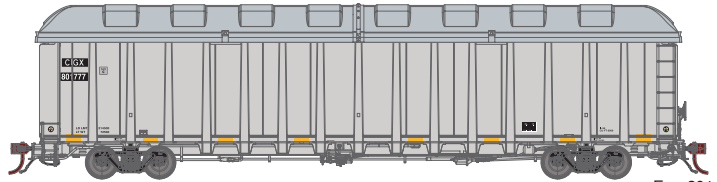

ATHG76728 CIGX #801777  
 ATHG76729 CIGX #801872  
 ATHG76730 CIGX #801839/801855

Era: 2014+

with cover

## American Railcar Leasing

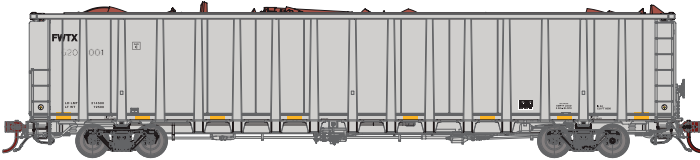

ATHG76731 FWTX #620001  
 ATHG76732 FWTX #620043  
 ATHG76733 FWTX #620053/620118

Era: 2008+

with scrap load

## West Coast Cooperative Road



ATHG76734 WCTX #527  
 ATHG76735 WCTX #558  
 ATHG76736 WCTX #526/571

Era: 2007+

with scrap load

### MODEL FEATURES:

- Nine Build Variations (Builds range to from 2006- Present)
- Multiple Body Styles
- Multiple Detailed End Variations
- Multiple Detail Top Chords
- Multiple Ladder Variations
- Metal Grab Irons
- Etched Metal Crossover Platforms (where applicable)
- Accurate Brake Piping (Metal and Plastic components)
- Newly-tooled Barber S-2-E, 100-ton trucks with animated bearing caps and printed road numbers
- Includes removable scrap load (non-covered versions only)
- Weighted to NMRA standards for reliable operation
- Body-mounted McHenry® lower shelf couplers (not shown)
- Minimum Radius 22" — Recommended Radius 24"

### PROTOTYPE AND BACKGROUND INFO:

Starting in 2006, National Steel Car began construction of these giant 6,400 cu ft capacity gondolas. These exquisite Athearn Genesis models capture all of the details and variations of their prototypes. Our state-of-the-art tooling replicates the nine build variations as well as multiple top chord and end variations. Separate details include full brake rigging, grab irons and etched crossover platforms. Add the definitive NSC 6400 gondolas to your modern roster with these all-new Athearn Genesis cars.

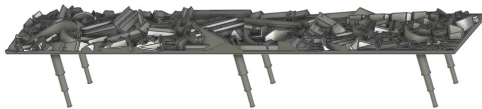

Drawing of removable scrap load  
 (Scrap load not included with covered versions)

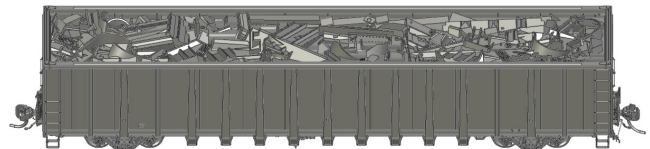

Drawing of removable scrap load in car

**\$64.99 INDIVIDUAL | \$109.99 2-PACK**

These items are subject to Horizon's MAP policy

Orders Due: 01.27.23  
 ETA: FEBRUARY 2024