

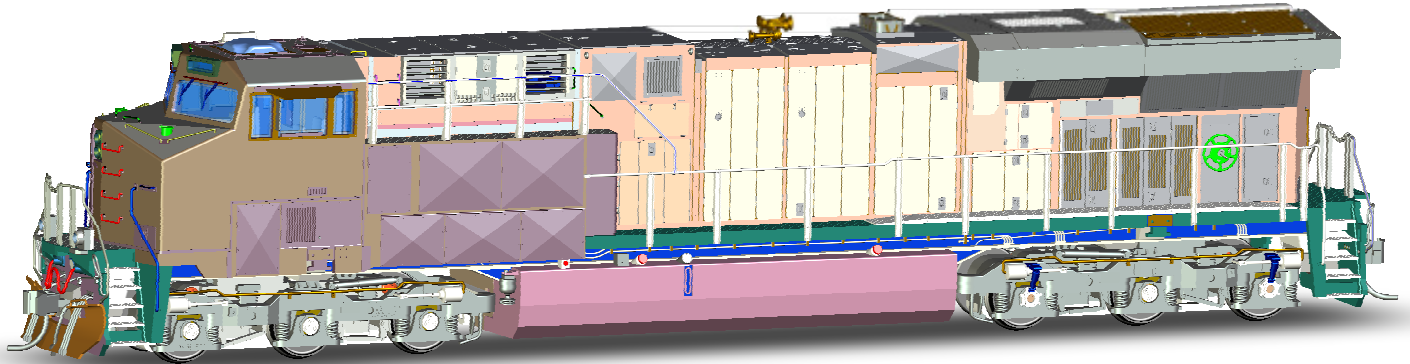

December 2024
DEALER ANNOUNCEMENT



HO
Scale

GE ES44AC GEVO LOCOMOTIVE

ADVANCE RESERVATION

Due to the lengthy time from the beginning of the Advance Reservation period for these locomotives, all Advance Reservations taken are being cancelled. We are beginning a new Advance Reservation period for these locomotives, which were on reservation before. We are starting over and expect to have production completed by mid-year! Please make your Advance Reservations for these locomotives so that we can go to production at the earliest possible time. All of these models will be equipped with a newly tooled drive with a larger motor and added weight for more pulling power. Each paint scheme has road name specific details for prototypical accuracy. We are looking forward to bringing this exquisite version of the ES44AC to market!



N
Scale

EMD SD40-2 LOCOMOTIVES

READY TO SHIP!

Eight colorful paint schemes of the N scale SD40-2 locomotives are ready to ship! Each scheme features specific details and multiple prototypical road numbers when available. All models are decorated with laser sharp decoration and are equipped with operating knuckle couplers. Please confirm your Advance Reservations as soon as possible as quantities are limited for some items.



SHOW TIME - COCOA BEACH PROTOTYPE MODELERS EVENT

If you are in the area stop by the Hilton Hotel in Cocoa Beach and visit the InterMountain display. Doug will be there to show samples of recent releases and answer any questions you may have! The Prototype Modelers Meet is on Friday and Saturday, January 10th and 11th!



NEW FACEBOOK PAGE!

Due to technical difficulties it has been necessary for InterMountain to reestablish its Facebook page. The new page can be accessed with the link below or the QR Code.
<https://www.facebook.com/intermountainrailwayco/>

Frank Angstead
InterMountain Railway Company



GE ES44AC GEVO



Features: Sharp Painting and Lettering, Multiple Road Numbers, Metal Wheelsets and Operating Knuckle Couplers.

Sound: \$329.95
DCC: \$249.95

49718(S)



951 - 997 Built Late 2011



3066 - 3174 Built 2013



CSX

(6 Numbers)

- * 6 road numbers
- * Alternating flash Front ditchlights
- * Large GPS Dome
- * GE "Steerable" trucks
- * Extended range dynamic brakes w/ 3 intakes

Car Numbers:

-05 969	-06 986	-07 995
-08 3087	-09 3123	-10 3099 * Spirit of West Springfield



GE ES44AC GEVO



Features: Sharp Painting and Lettering, Multiple Road Numbers, Metal Wheelsets and Operating Knuckle Couplers.

Sound: \$329.95
DCC: \$249.95

49733(S)



Arcelor Mittal

(2 Numbers)

- * Front and rear ditchlights
- * Large GPS Dome
- * Standard Hi-Ad trucks
- * Extended range dynamic brakes w/ 3 intakes

Car Numbers:

-11 301 -12 302

49741(S)

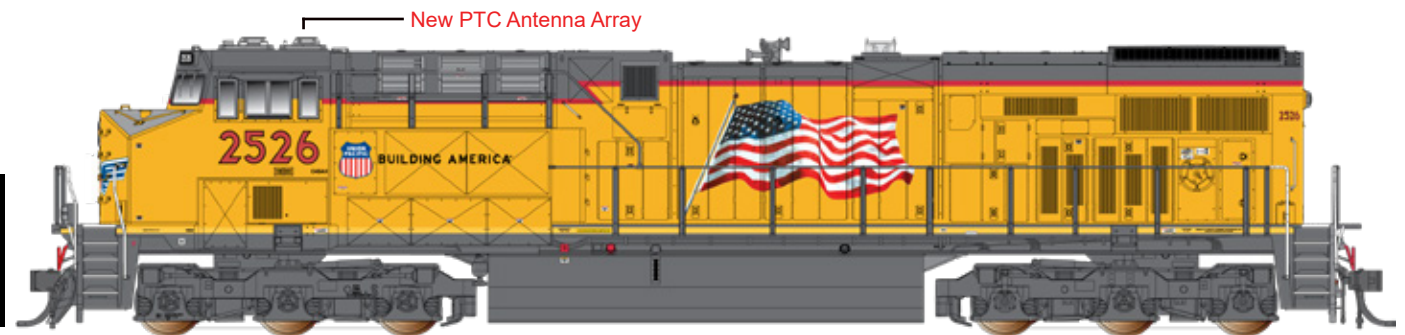

C45AH Union Pacific

(6 Numbers)

2520 - 2569 Built 2013

Car Numbers:

- * Six road numbers
- * Front ditch lights
- * Cab PTC
- * Standard Hi-Ad trucks
- * Extended range dynamic brakes w/ 3 intakes

-11 2526 -12 2528 -13 2534
-14 2537 -15 2539 -16 2555

New PTC Antenna Array

49743(S)



Burlington Northern Santa Fe

(6 Numbers)

4211 - 4299 Built Late 2015/ Early 2016

Car Numbers:

- * Six Road Numbers
- * Front ditch lights
- * Cab PTC
- * Hi-Ad A1A truck type with extra brake cylinders
- * Standard dynamic brakes w/ 2 intakes
- * Tier 4 Credit Order

-15 4229 -16 4247 -17 4264
-18 4270 -19 4287 -20 4296



GE ES44AC GEVO



Features: Sharp Painting and Lettering, Multiple Road Numbers, Metal Wheelsets and Operating Knuckle Couplers.

Sound: \$329.95

DCC: \$249.95

49745(S)



Citi Rail

(6 Numbers)

1201 - 1214 Built 2012

Car Numbers:

1402 - 1435 Built 2014

-07 1204 -08 1208 -09 1211

-10 1403 -11 1416 -12 1428

- * Six road numbers
- * Front and rear ditchlights
- * Large GPS Dome
- * Standard Hi-Ad trucks
- * Standard dynamic brakes w/ 2 intakes

49746(S)



Florida East Coast

(4 Numbers)

800 - 823 Built 2014

Car Numbers:

-05 803 -06 808 -07 814 -08 819

- * Four road numbers
- * Alternating flash Front ditch lights
- * Large GPS Dome
- * Hi-Ad A1A truck type with extra brake cylinders
- * Standard dynamic brakes w/ 2 intakes

49783(S)



Canadian National

(4 Numbers)

2801 - 2825 Built 2012

Car Numbers:

-01 2801 -02 2814 -03 2817 -04 2822

- * Four road numbers
- * Front and rear ditchlights
- * Large GPS Dome
- * Standard Hi-AD trucks
- * Operating front and rear red warning lights
- * Standard dynamic brakes w/ 2 intakes



GE ES44AC GEVO



Features: Sharp Painting and Lettering, Multiple Road Numbers, Metal Wheelsets and Operating Knuckle Couplers.

Sound: \$329.95

DCC: \$249.95

49784(S)



Canadian Pacific

(4 Numbers)

8900 - 8960 Built 2011

Car Numbers:

- * Four road numbers
- * Non-flashing Front and rear ditchlights
- * Large GPS Dome
- * Standard Hi-Ad trucks
- * Standard dynamic brakes w/ 2 intakes

-01 8916 -02 8933 -03 9351 -04 9379

Updated 21-pin Motherboard

Additional Weight

Updated Electronics

Front and Rear Contact Tabs for Bright Ditchlights

Enhanced Frame Detail

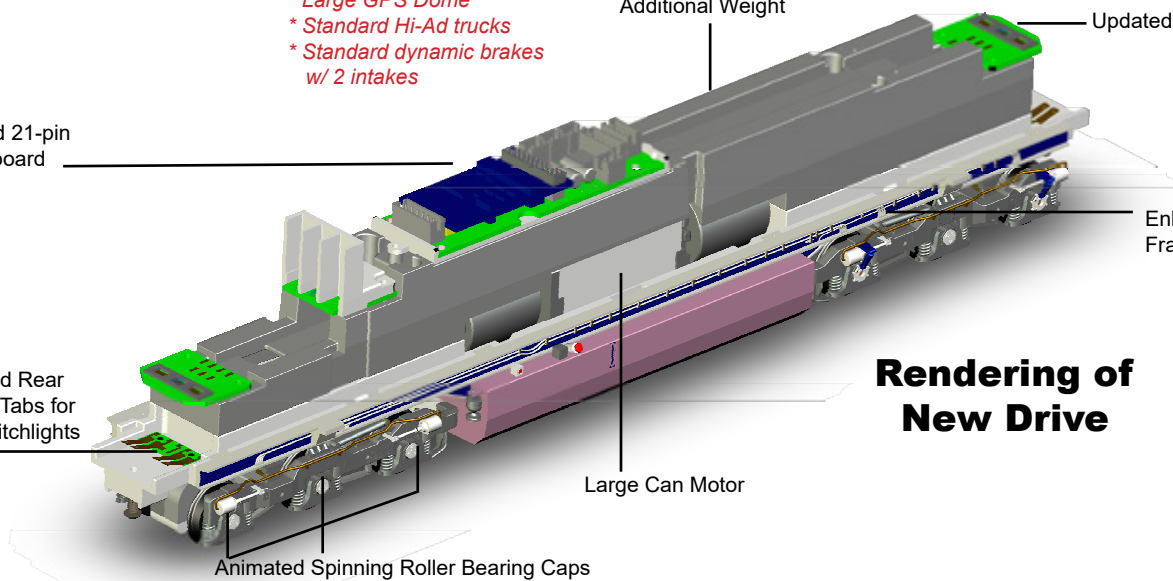

Rendering of New Drive

Large Can Motor

Animated Spinning Roller Bearing Caps

MODEL FEATURES:

- Fully-assembled and ready-to-run
- DCC-equipped features Lok Pilot DCC decoder installed on a 21-pin connector motherboard
- Scaled from prototype resources including drawings, field measurements, photographs, and more
- Accurately-painted and -printed paint schemes
- Coupler cut levers
- MU hoses
- Trainline hose
- See through cab windows
- Full cab interior
- Walkway tread
- Fine-scale Celcon handrails for scale appearance
- Windshield wipers
- Lift rings
- Wire grab irons
- Detailed fuel tank with fuel fillers, fuel gauges, breather pipes, and retention tanks
- Metal knuckle couplers - Kadee compatible

- Driveline with 5-pole skew wound motor, precision machined flywheels, for trouble free operation
- All-wheel drive with precision gears for smooth and quiet operation
- All-wheel electrical pickup provides reliable current flow
- Wheels with RP25 contours operate on all popular brands of track
- Animated spinning roller bearing caps
- LEDs for realistic appearance
- Bidirectional constant lighting so headlight brightness remains constant
- Heavy die-cast frame for greater traction and more pulling power
- Packaging securely holds for the model for safe storage
- Sound equipped models also feature
- Onboard DCC decoder with ESU Lok decoder
- Sound units operate in both DC and DCC
- Some functions are limited in DC
- Engine, horn, and bell sounds work in DC
- All functions NMRA compatible in DCC mode
- Slow speed control
- Program a multiple unit (MU) lashup with lead unity only horn, bell, and lights
- Many functions can be altered via Configuration Value (CV) changes